

KingsGate School Create & Celebrate and Pet Day

Friday 28th September 2018

There are more details on the following pages, but here is a checklist.

Preparation Check List

NOW...

Bean Growers:

- Decorate your container

Room 1, 2, 3, 4 and 5 (all students) collect ...

- Saucer (traditional plain china saucer)

Room 1, 2, 3 and 4 collect ...

- Jar – large enough for flax (soak in hot soapy water to remove label and glue)

Room 5 only collect ...

- Unusual container – large enough for flax (must be able to hold water in some way)

Room 2, 4 and 5 collect ...

- Jar with watertight, screw top lid for aqua jar (soak in hot soapy water to remove label)

We have a small number of saucers, etc available for loan but please do your best to supply your own from your own cupboards, or family, friends or the second hand shops as we cannot supply for the whole school. Any school items will need to remain at school at the conclusion of Pet Day.

☺ ***Turn over...***

Next Week – Week 10

Monday/Tuesday

- Bring saucers, jars, etc to school (this will save you thinking about so much on Thursday and allow us to see who needs help)
Room 5 – you may want to bring your unusual container on Thursday to keep it as a surprise.

Wednesday After School

Pick flowers and flax – put them in a bucket of water

Room 1, 2, 3, 4 and 5 (all students) collect ...

- Flowers, like daisies (with 'flat' petals, suitable to use petal by petal, possibly tiny flat leaves) (Vaseline saucer)
- 3 flowers or 3 stems of flowers (big enough for flax arrangement)
- About 7 pieces of flax

Room 1 and 3 collect ...

- 1 small/medium flower or 1 stem of small flowers (buttonhole)
- 1 piece of fern (buttonhole)

Room 2, 4 and 5 collect ...

- 1 single flower or 1 single stalk of flowers (aqua jar)

Thursday Morning - Create & Celebrate

- Bring your flowers and flax, etc to school
- Bring your Beans to school in their decorated containers

Thursday After School

- If your pet is coming to school, prepare your pet, clean their cage, get their water or food ready
- Prepare a plate of finger food for the shared morning tea, big enough for all your guests

Friday Morning - Pet Day

- 8.30am – Come to school wearing mufti (home clothes, not school uniform)
- Bring your pet and their supplies to school
- Bring your plate of food for the shared morning tea
- Take indoor pets to the door of your child's classroom
- Take outdoor pets to the area beside the field, behind Room 5
- Parents, family and friends come to school, Pet Day starts at 9.00am

KingsGate School

Create & Celebrate

and Pet Day

Friday 28th September 2018

Dear parents,
Here is some information about our annual Pet Day and Create & Celebrate display.

Floral Exhibits:

This afternoon students who have not been a part of a KingsGate Pet Day were shown how to make the different floral exhibits that are part of our event this year.

Students who wish to can have fun practising making a Vaseline saucer, twisting flax or making flax flowers, etc. at home.

Next Wednesday afternoon...

Please pick enough flowers and flax for each of your children to complete the below entries and send them to school next Thursday morning, 27th September.

If you have enough to share, please send let me know.

PLEASE NOTE: EACH CLASS WILL WORK ON THEIR ENTRIES IN THEIR OWN CLASSROOMS, THEREFORE EACH CHILD NEEDS THEIR OWN FLOWERS IN THEIR OWN CONTAINERS.

These are the entries your child will make.

<p>Room 1 and 3 (Mrs Farley and Mrs Labuschagne)</p> <p><i>Vaseline Saucer</i> <i>Flax & 3 Flower Jar</i> <i>Buttonhole</i></p>	<p>Room 2 and 4 (Miss Yelchich and Miss Tetley-Jones)</p> <p><i>Vaseline Saucer</i> <i>Flax & 3 Flower Jar</i> <i>Aqua Jar</i></p>	<p>Room 5 (Mr Clark)</p> <p><i>Vaseline Saucer</i> <i>Flax and 3 Flower in an Unusual Container</i> <i>Aqua Jar</i></p>
--	---	--

Hints for when selecting your flowers or practising at home:

Pick your flowers the night before. Put them in a bucket with water up to their "necks" overnight and they will last better the next day.

Vaseline Saucer – all children

Students use a traditional plain china saucer, smeared with Vaseline, to create a pattern with petals of flowers, like daisies. The petals are pulled off the flower and stuck flat to the saucer. Leaves can be used as long as they stick flat to the saucer. The school provides the Vaseline.



Flax & 3 Flower Jar – Room 1, 2, 3, 4

Students use a large clean jar (*not a vase*) to make an arrangement with approximately 7 pieces of flax (curled, twisted and stapled, or woven into flowers) and 3 flowers or 3 stalks of flowers. **PLEASE NOTE:** Any variety of flowers may be used however remember they go into a jar with large pieces of flax so need to be big enough to look right.



Flax & 3 Flower in an Unusual Container – Room 5

Students make an arrangement with approximately 7 pieces of flax (curled, twisted and stapled, or woven into flowers) and 3 flowers or 3 stalks of flowers. They then creatively display it in an unusual container that must be able to hold water in some way, to ensure the flowers do not die. Remember it will need to be large enough for the flax.

PLEASE NOTE: Any variety of flowers may be used however remember they go into a jar with large pieces of flax so need to be big enough to look right.



Buttonhole – Room 1 and 3

Students use 1 small flower or 1 stem of small flowers with a sprig of fern to create a buttonhole by wrapping tinfoil around the stalks. The school will provide the tinfoil.



Aqua Jar – Room 2, 4 and 5

Students use a jar with a screw lid that seals well and 1 single flower or 1 single stalk of flowers to create the aqua jars. The jar must be clean for the best result. Soaking it in hot soapy water will help remove the label and glue. The flower is checked for height and then stuck to the inside of the lid using Blu-Tack. The lid and flower are put into a large bucket of water and the air bubbles that form between the petals removed. The jar is then filled with water and the flower inserted into the water with the lid screwed on tight! The jar is then dried and stood on the lid. The best result is for the jar to have few or no air bubbles in it.



Please ask if you would like any further information.

Shared Morning Tea

Please bring a plate of food to share for morning tea. If you have a lot of guests coming please adjust your plate size accordingly. This is a great time to stand and chat with different members of the school community and visitors.

Please note: With our schools increased size and our limited space it is more difficult to provide hot drinks. This year *we encourage you to bring your own hot drink*. Water with lemon slices will be offered for adults. Students will be encouraged to use the water fountain as in previous years.

Thank you to those who have volunteered to help set up, serve and clean up morning tea. We appreciate you serving in this way and want you to still be able to take part in the different

activities of the day around your serving. Please see Lydia Walraven and Lydia Loveday, who will head this team, when you arrive.

Pet Day is a School Day

Pet Day is an official school day and it is compulsory for children to attend. Children are to wear mufiti (that is home clothes, not uniform) as this is more suitable when working with animals.

Please... Pray for fine weather!
Invite your family and friends to join us
and come ready for a great day.

If you have any questions, please see me.
Thank you for your support.

Johanne Farley
On behalf of the KingsGate staff.

PLEASE REMEMBER
Pet Day **finishes**
at approximately **12.00pm.**
At that time children
may leave with their parents.
CHILDREN PLEASE say goodbye
to your teacher so that they know
you are leaving.

Where do I go?

Here is a map to help you know where to go on Pet Day.

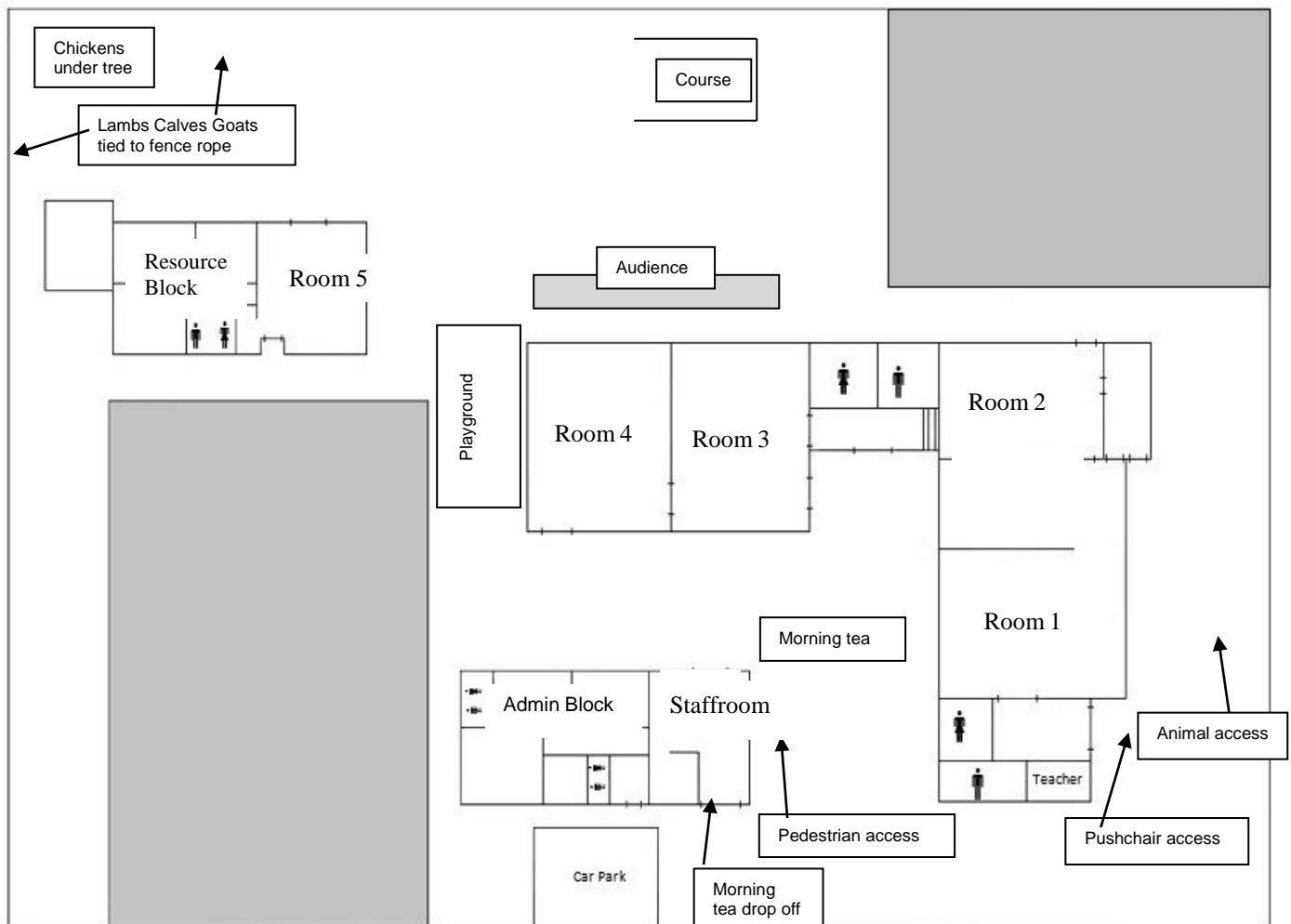

**PLEASE REMEMBER – THERE IS NO ACCESS TO CLASSROOMS
UNTIL AFTER THE REARED ANIMAL JUDGING.**

Pet Day and Create & Celebrate Programme Friday 28th September 2018

- 8.45am Reared animals tethered/caged outside
Domestic pets caged in child's classroom
Children go and sit on tarps
Classrooms closed to public
Visitors directed to seating
- 9.00am Welcome – Open in Prayer
Housekeeping
- 9.15am *Reared Animals*
Lamb Judging

Calf Judging

Chickens
- 10.00am (approximately)
Classrooms open for viewing of indoor exhibits – please move throughout all the classrooms to see everyone's work
- 10.45am Shared Morning Tea (sorry no hot drinks)
Free time to enjoy exhibits and animals
- 11.30am Presentation of Points Prize certificates – beside back deck behind Staffroom
- 12.00pm Children will be directed to collect and take home...
All indoor exhibits on tables
(excluding items borrowed from school, and art on walls),
All certificates
And all pets!

Children must see their teacher before leaving with their parents.

Help with clean-up will be appreciated.

Please note:

As **times are approximate**, if you are planning to come for a specific part of the day, please allow for some flexibility in the times.

Parents please help supervise your children, particularly around the animals.